

Orderer / Customer:  TRADE SECRET

Object / Test specimen: Double wall Noble drawer

Model no.: 908SH-A86

Order: Mechanical test on safety requirements

**Statement:**

**The overall test result: Passed**

The Double wall Noble drawer was tested according to the mechanical safety requirements for domestic use and following the parameter "column 2" according to Table C.1 and Table C.2 of EN 15338: 2010. The tests were carried out between September 23, 2011 and September 26, 2011. The tests were conducted according to EN 15338: 2010, EN ISO 6270-2: 2005 and with respect to the present state of safety engineering.

Technical data and test results can be seen in the following test report.

The tests were carried out in indoor ambient conditions at a temperature between 15°C – 25°C. The test report consists of 9 pages.

**Note:** Detailed information regarding measurement uncertainty is available in the test lab and could be shown on customer request. Deviation report in Simplified Chinese is available on client's request.

Guangzhou, September 28, 2011

**TÜV Rheinland (Guangdong) Ltd.**  
Hardlines \ Furniture Productline

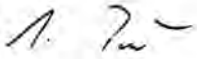

Stephan Pesch  
Department Manager

Person in Charge



Waley Huang  
Project Engineer

**Item:**

Article: Double wall Noble drawer  
Article no: 908SH-A86  
Number of samples: 3 pcs  
Supplier:  TRADE SECRET  
Received on: August 31, 2011

**Scope of testing:**

General tests:

The following mechanical tests according to EN 15338: 2010, EN ISO 6270-2: 2005:

- Functional load and overload test
- Durability test
- Corrosion resistance
- Product information system

**Scope of the test results:**

This test report relates to the a. m. test sample. Without permission of the test center this test report is not permitted to be duplicated in extracts. This test report does not entitle to carry any safety mark on this or similar products.

**General tolerances:**

Unless otherwise specified the accuracy of the linear dimension is defined according to DIN 7168-g relating to old design and DIN ISO 2768 part 1 „c“ for new design. For all other physical dimensions the uncertainty of measurement shall have an accuracy of < 5 % of the nominal force. The tests are performed in common room climate.

**Test standards for mechanical tests:**

EN 15338: 2010 Hardware for furniture - Strength and durability of extension elements and their components  
EN ISO 6270-2: 2005 Paints and varnishes - Determination of resistance to humidity - Part 2: Procedure for exposing test specimens in condensation- water atmospheres

and with respect to the present state of safety engineering following to the German Equipment and Safety Act

**Dimensions:**

**Outer dimension**

Height:	90 mm
Depth:	517 mm
Width:	447 mm
Front height:	183 mm

**Inner dimension:**

Height:	127 mm
Width:	377 mm
Depth:	475 mm
Extension length (n <sub>x</sub> ):	485 mm

Weight of drawer:	5.6 kg	
Weight of the slide:	1.8 kg	
Loading capacity (M):	35.0 kg	<input checked="" type="checkbox"/> with catch device

**Pictures:**

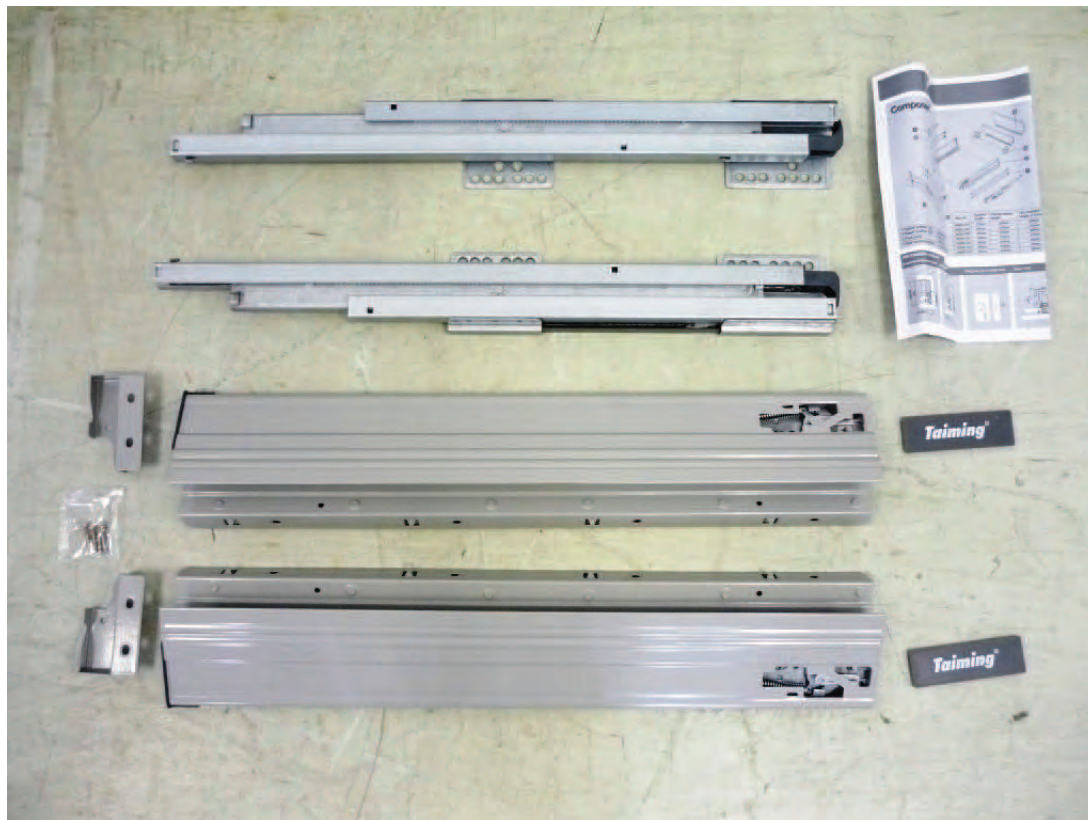

Pic. 1: Overview



Pic. 2: Detail view of drawer part



Pic. 3: Detail view of slide part \_1



Pic. 4: Detail view of slide part \_2

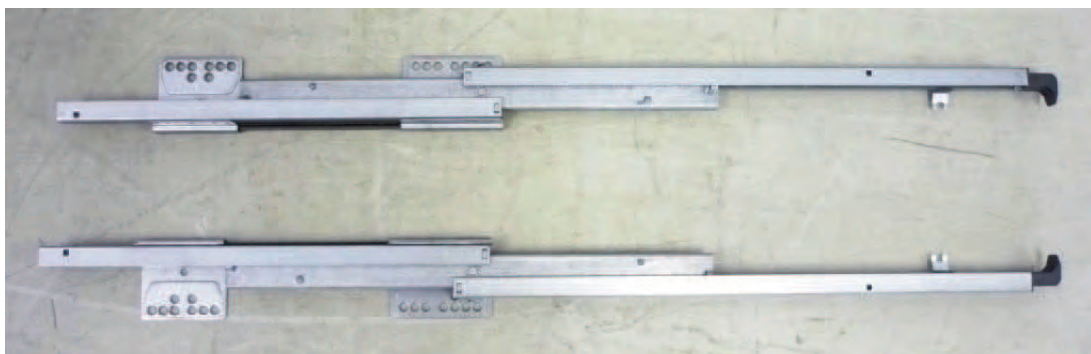

Pic. 5: Detail view of slide part \_3



Pic. 6: Detail view of slide part \_4



Pic. 7: View of whole drawer

**Objections:**

None

**Recommendation:**

None

**Remark(s):**

1. Only the new product information was updated, all other data and results were taken from previous report No. 173062027/GZF/01-01, dated on September 16, 2011.
2. The test frame and the test drawer (cl. 5.6 of EN 15338: 2010) are specified by the manufacturer
3. The identification of the manufacturer and product is missing, detail requirements see page 8. The marking must be attached during mass production.

**1.**

**Technical tests:**

**Double wall Noble drawer**

**Verdict**

**Overload tests (according to Cl. 6.2 of EN 15338: 2010):**

Vertical downwards static overload	Passed
Horizontal sideways static overload	Passed
Outwards static overload	Passed
Slam-shut/open	Passed

**Functional tests (according to Cl. 6.3 of EN 15338: 2010):**

Deflection of extension element bottoms	Passed
Deflection of front and back	Passed
Operating forces	Passed
1 <sup>st</sup> vertical downwards static load	Passed
1 <sup>st</sup> horizontal sideways static load	Passed
Durability	Passed
Deflection of front	Passed
2 <sup>nd</sup> vertical downwards static load	Passed
2 <sup>nd</sup> horizontal sideways static load	Passed
Operating forces	Passed
Slam-shut/open	Passed

**Corrosion resistance (according to Cl. 6.4 of EN 15338: 2010):**

Requirement: 3 cycles AHT of EN ISO 6270-2: 2005.	Passed
---	--------

**Product information system (according to Annex A of EN 15338: 2010):**

Field of application	Passed
Loading capacity	Passed
Open stops information	Passed
Max. height of the front	Passed
Corrosion test	Passed

**Assembly Instruction (2 PfG L 0088/12.09):**  
Instruction manual

Passed

**Indication according to the Equipment and Product Safety Act (GPSG):**

**Identification of the manufacturer**

Not provided

Name and address of an authorized person (manufacturer or importer) based in the European Economic Area (EEA) must be affixed to products or its packaging, which are intended to be sold in the single European Union market.

**Identification of the product**

Not provided

The product must be marked in such a way that it is possible to identify it clearly (e.g. by art No, batch No, production time etc.).

**Test according to the textile marking law**

Not applicable

Note to the law on textile marking (TKG):

According to the law on textile marking, the textile shall be marked with the proportional weight quantity of the raw materials used. The marking shall be given directly on the article itself or on the sales packaging for the end consumer. Within the scope of the performed test, no determination of the material was carried out with regard to this.

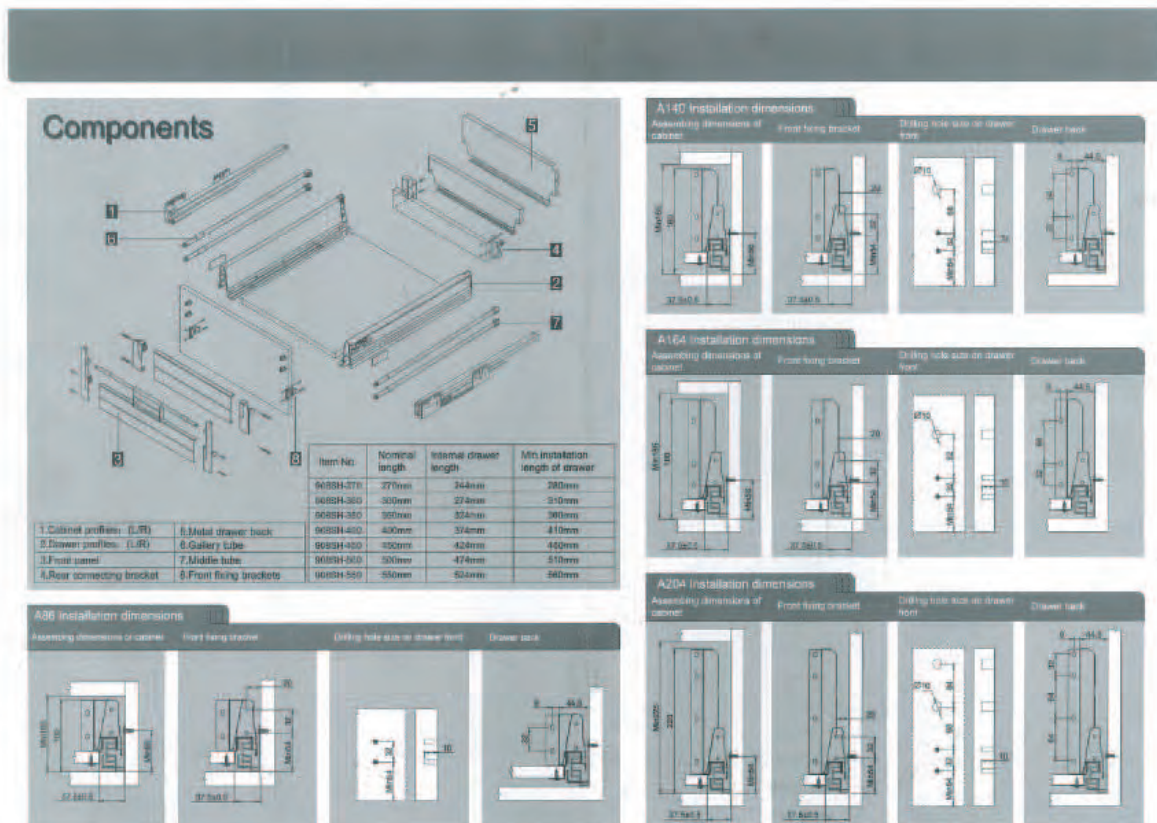



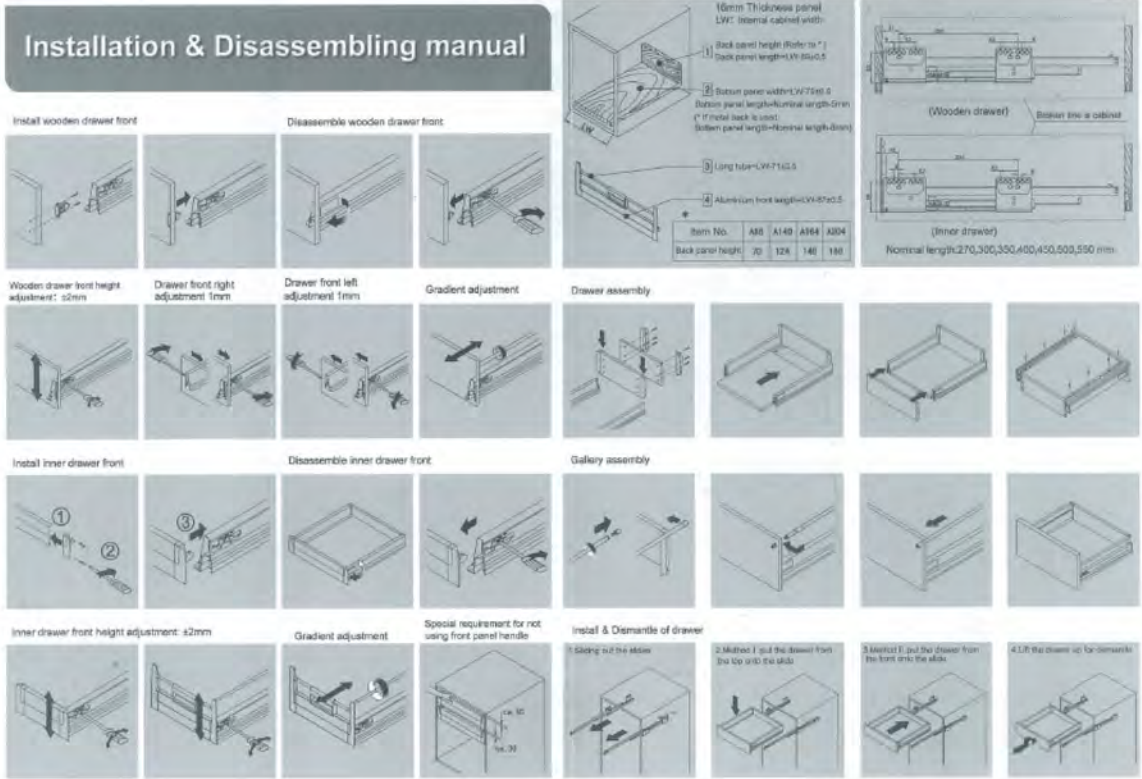

Pic. 9: Assembly instruction (2/2)



**Product Specifications**  
 → Suitable for all kinds of home furniture such as bathroom vanities, kitchen cabinets and so on.  
 → Materials of the furniture can be chipboard, solid wood, particle board, MDF, steel.  
 → Loading capacity: 35kgs.  
 → Drawer can fully open to the end with safety stop and damping at the stop position.  
 → The maximum height of the drawer front is 200mm.  
 → Corrosion test: it passed 3 cycles AHT of EN ISO 6270-2:2005 according to Cl. 6.4 of EN 15338:2010.  
 → Product passed all the tests according to the requirements of EN 15338:2010, Column 2.

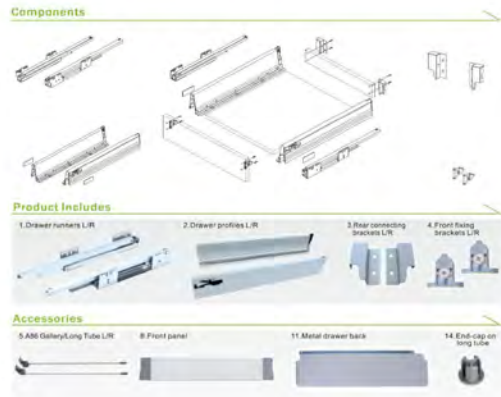

Assembly & Specifications  
(see page 15)

SLIDES SPECIALIST FOR 30 YEARS

Pic. 10: Product information

- End of Test Report -